



# 6022 NR Deep groove ball bearings

- SKF Explorer

## Deep groove ball bearings

### Bearing data

[Tolerances](#),

Normal (metric), P6, P5, Normal (inch),

[Radial internal clearance](#),

Matched bearing pairs, Stainless steel  
 $d < 10$  mm, Other bearings

### Bearing interfaces

[Seat tolerances for standard conditions](#),

[Tolerances and resultant fits](#)

## Technical specification

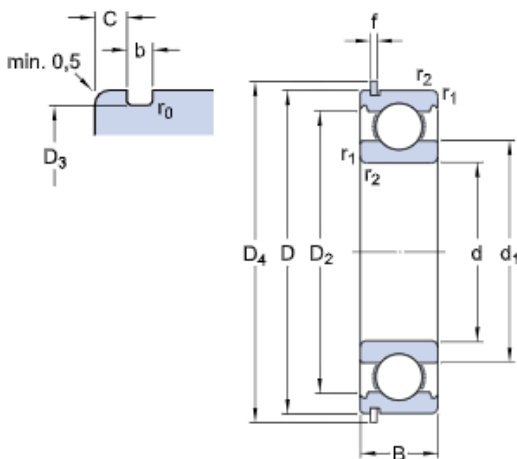

### DIMENSIONS

d	110 mm	Bore diameter
D	170 mm	Outside diameter
B	28 mm	Width
$d_1$	≈ 129.05 mm	Shoulder diameter
$D_2$	≈ 155.3 mm	Recess diameter
$D_3$	163.65 mm	Diameter of snap ring groove
$D_4$	182.9 mm	Outside diameter of snap ring
b	3.5 mm	Width of snap ring groove
C	3.71 mm	Distance outer ring from side face to snap ring groove
f	3.1 mm	Width of snap ring
$r_0$	max. 0.6 mm	Bottom radius of snap ring groove
$r_{1,2}$	min. 2 mm	Chamfer dimension

### ABUTMENT DIMENSIONS

$d_a$	min. 119 mm	Diameter of shaft abutment
$D_a$	max. 161 mm	Diameter of housing abutment
$D_b$	min. 185 mm	Diameter of snap ring recess in the housing

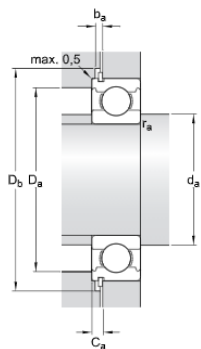

$b_a$	min. 4 mm	Width of snap ring recess in the housing
$C_a$	max. 6.81 mm	Distance from outer ring side face to snap ring back face
$r_a$	max. 2 mm	Radius of shaft or housing fillet

CALCULATION DATA

C	85.2 kN	Basic dynamic load rating
$C_0$	73.5 kN	Basic static load rating
$P_u$	2.6 kN	Fatigue load limit
	8 000 r/min	Reference speed
	5 000 r/min	Limiting speed
$k_r$	0.025	Minimum load factor
$f_0$	15.6	Calculation factor

MASS

	2.04 kg	Mass bearing
--	---------	--------------

INCLUDED PRODUCTS

SP 170	Snap ring
--------	-----------

TOLERANCE CLASS

P6	Dimensional tolerances
Normal	Radial run-out